





# PROJECT SUMMARY REPORT

May 2018



Concourse D will feature a live music stage.  
(conceptual image)



Concessions and aircraft gates in the new concourse.  
(conceptual image)

## AT A GLANCE

- New, **115,000**-square-foot Concourse D
- **6** new domestic aircraft gates
- New **dining** and **retail** offerings
- Expanded **Ticketing Lobby**
- **4** additional Baggage Claim carousels
- New **Central Utility Plant**
- **Sustainability: Pursuing LEED v4 Certified or Silver** rating
- Currently in design
- **Groundbreaking: June 20, 2018 at 11 a.m.**
- Opening **Summer 2020**

## TOTAL PROJECT BUDGET

- \$268 million

## CONSTRUCTION TIMELINE

- **Central Utility Plant:**
  - Construction begins **Summer 2018**
- **Terminal Wings:**
  - North: Construction begins **Summer 2018**
  - South: Construction begins **Spring 2019**
- **New Concourse D:**
  - Construction begins **Fall 2018**

## SMWBE PARTICIPATION <sup>1</sup>

	GOAL	ACHIEVED
<b>MBE PARTICIPATION</b>	<b>6.29%</b>	-
<b>WBE PARTICIPATION</b>	<b>9.13%</b>	-
<b>SBE PARTICIPATION</b>	<b>4.0%</b>	-

## WORK FORCE <sup>2</sup>

- **Total # of Workers: 73**
- **Regional Labor: 46%**
- **Total Hours Worked: 16,000**

## WORK FORCE BY COUNTY <sup>3</sup>

- **OTHER**
- **DAVIDSON**

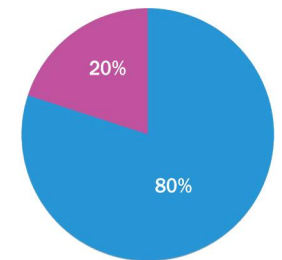

<sup>1</sup> As of **3/31/2018**

<sup>2</sup> As of **5/1/2018**

<sup>3</sup> As of **5/1/2018**  
(estimated)

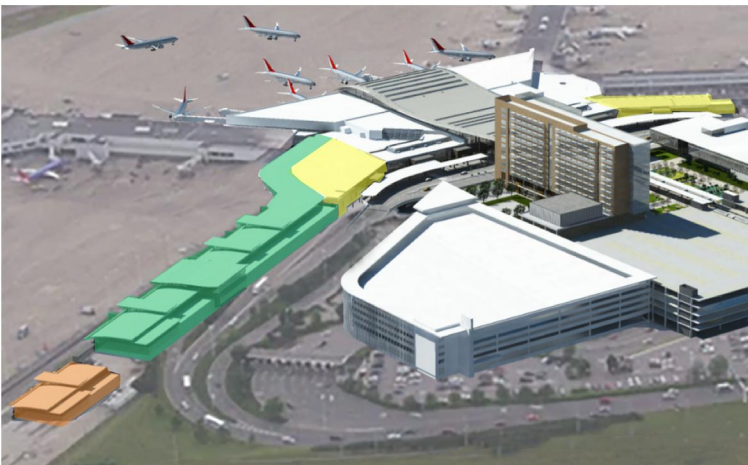

- **Concourse D**
- **Terminal Wings Expansions**
- **Central Utility Plant**